

HARRIS WASTE MANAGEMENT GROUP  
BAXLEY, GEORGIA

DATE 9/12 2013	DEALER	CUSTOMER WASTE MANAGEMENT
DRAWN BY: MARK	UL APPROVAL:	MODEL #: HRB 240-T100
SERIAL #: 8831	DRAWING #: 130463 SH 8	DESCRIPTION: CONTROLS 1

	1	2	3	4	5	6	7	8	9	10	11	12	13	14	15	16	17	18	19	20	21	22	23
A																							
B																							
C																							
D																							
E																							
F																							
G																							
H																							
I																							
J																							
K																							
L																							
M																							
N																							
O																							
P																							
Q																							

HARRIS WASTE MANAGEMENT GROUP BAXLEY, GEORGIA		
DATE: 8/12 2013	DEALER	CUSTOMER WASTE MANAGEMENT
DRAWN BY: MARK	UL APPROVAL:	MODEL #: HRB 240-T100
SERIAL #: 8831	DRAWING #: 130463 SH 4	DESCRIPTION: SPARE SHEET

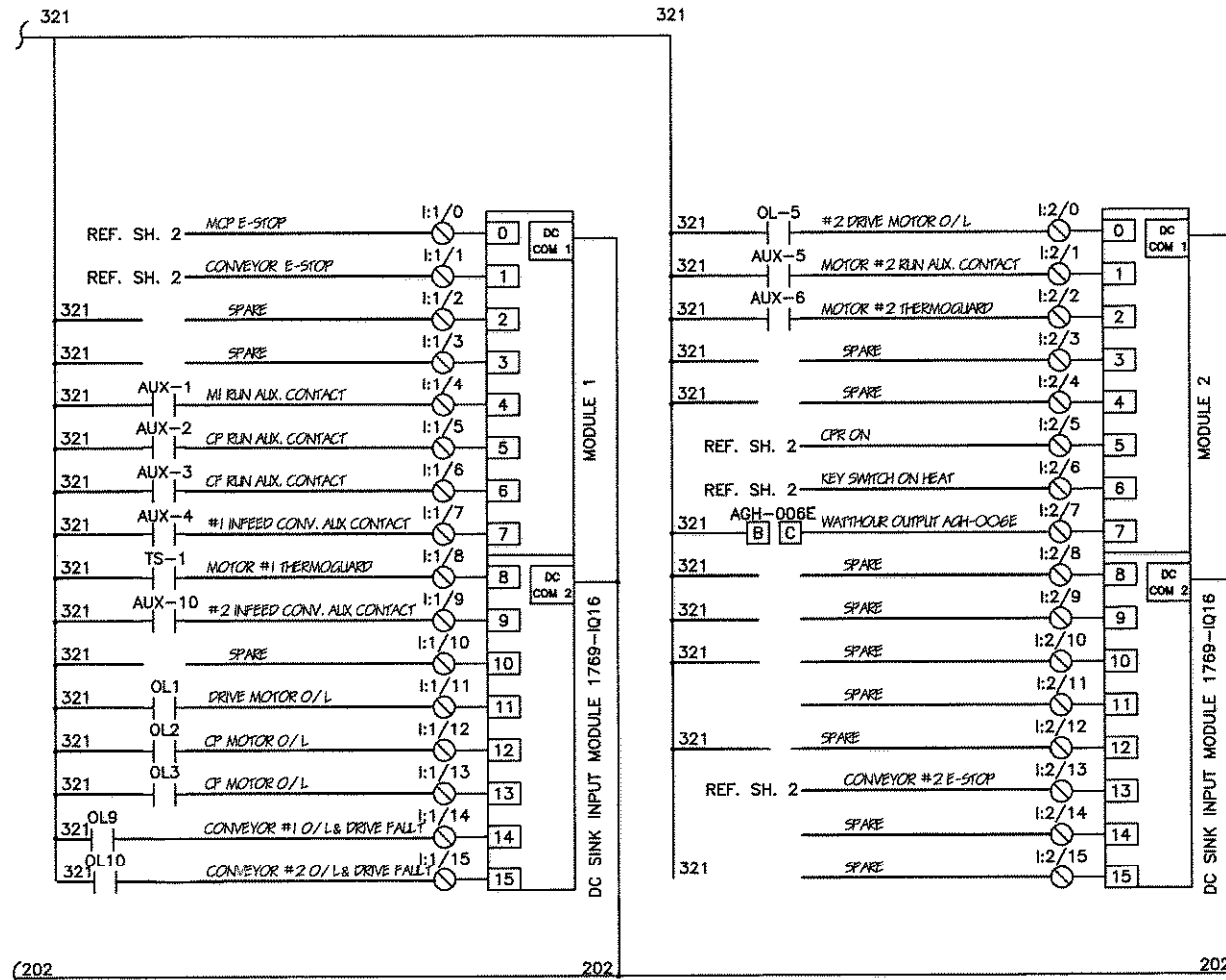

<b>HARRIS WASTE MANAGEMENT GROUP</b>		
<b>BAXLEY, GEORGIA</b>		
DATE 9/12 2013	DEALER	CUSTOMER WASTE MANAGEMENT
DRAWN BY: MARK	UL APPROVAL:	MODEL #: HRB 240-T100
SERIAL #: 8831	DRAWING #: 130463 SH 5	DESCRIPTION: <b>DC INPUTS</b>

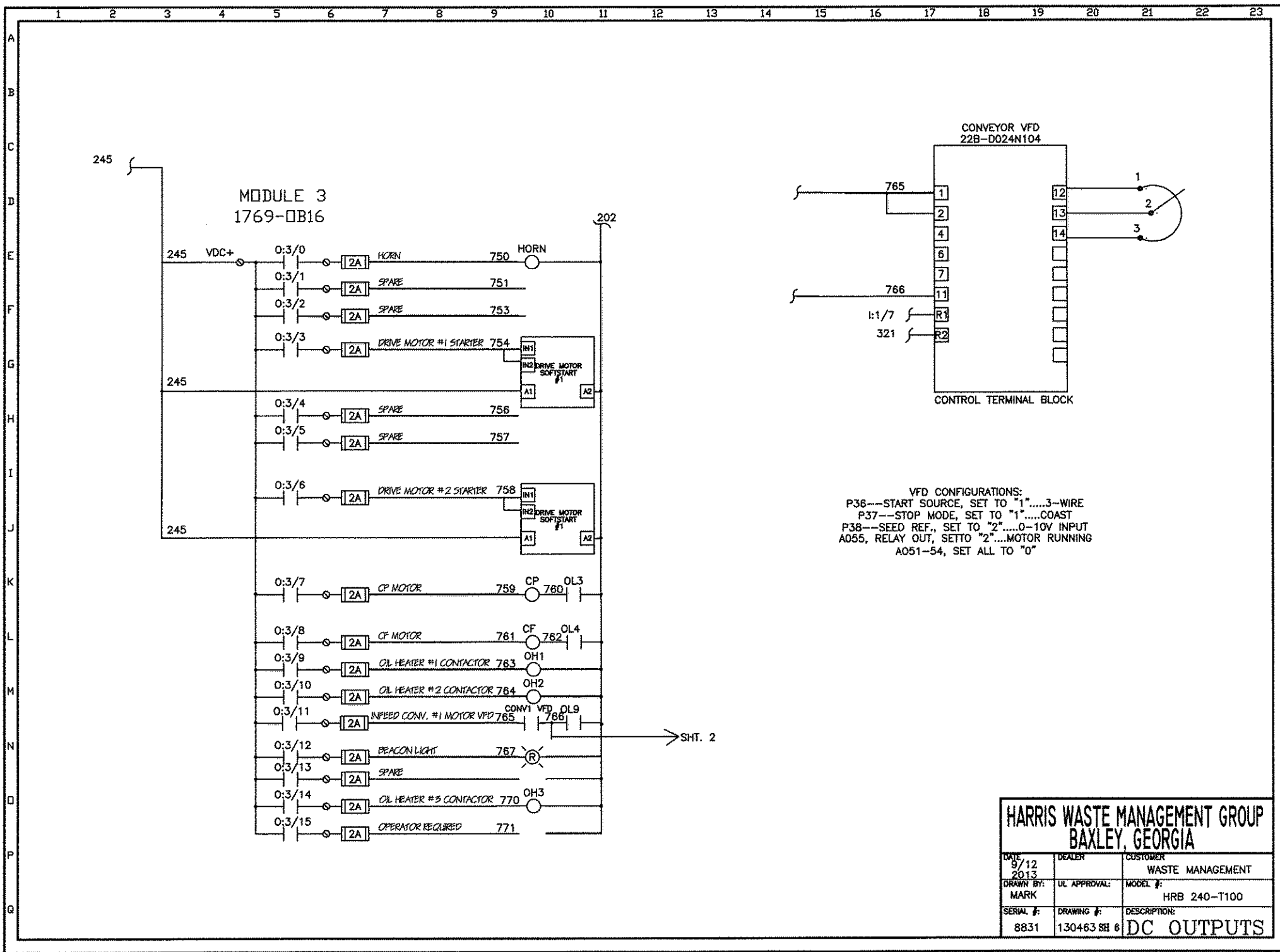

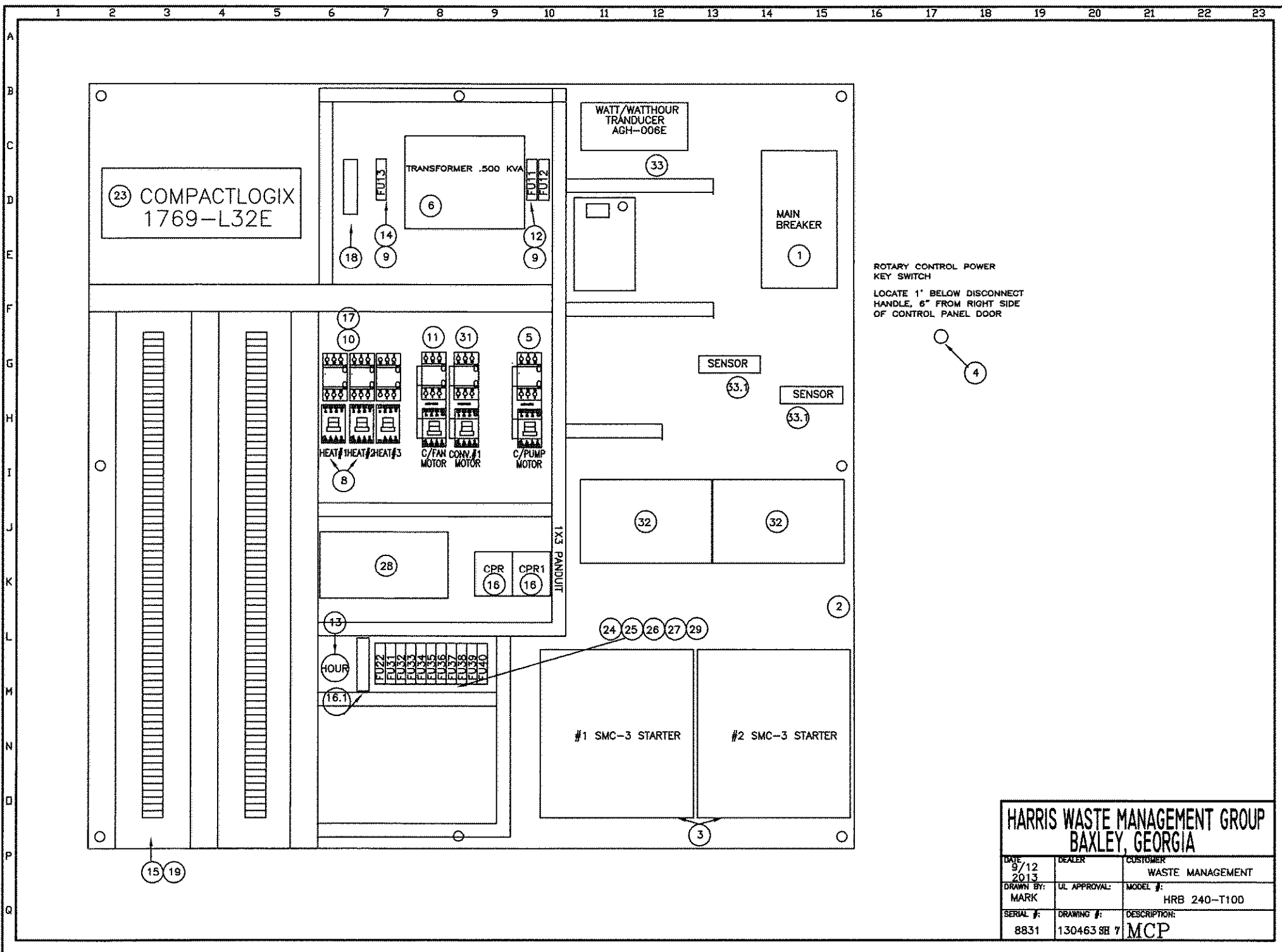

HARRIS WASTE MANAGEMENT GROUP BAXLEY, GEORGIA		
DATE 9/12 2013	DEALER	CUSTOMER WASTE MANAGEMENT
DRAWN BY: MARK	UL APPROVAL:	MODEL #: HRB 240-T100
SERIAL #: 8831	DRAWING #: 130463 8B 7	DESCRIPTION: MCP

INV #	ITEM	QTY.	DESCRIPTION	MANUFACTURER	PART NUMBER
870239	1	1	BREAKER 400A FLNG MT & ACCS	GE	SRPG400A400
870939	2	1	ENCL 60X61X12 FLNGMNT	HOFFMAN	A60X6112LPFTC-MOD
870940	2.1	1	ENCL 60X61X12 BACKPLATE	HOFFMAN	A60P60
871851	2	2	SMC-3	ALLEN-BRADLEY	150-C135NBR
870691	3.1	2	AUX CONTACT 1-NO/NC	ALLEN-BRADLEY	150-CA11
871126	3.2	2	MODULE PROTECTIVE	ALLEN-BRADLEY	150-F84L
871852	3.3	2	CONTACTOR IEC TERMINAL COVER	ALLEN-BRADLEY	150-TG1
858861	3.4	4	IEC LUG KIT	ALLEN-BRADLEY	199-LF1
871532	4	1	SWITCH ROTARY KEY CODE	ALLEN-BRADLEY	440T-MRPSE10AA
870096	5	1	CONTACTOR IEC 43 AMP 24VDC COIL	ALLEN-BRADLEY	100-C43DJ10
869151	5.1	1	CONTACTOR 140M 32-45 AMP	ALLEN-BRADLEY	140M-C2E-C16
869049	5.2	1	CONTACTOR FRONT MOUNT AUX. CONTACT	ALLEN-BRADLEY	140M-C-AFA11
870332	6	1	TRANSFORMER 2000 KVA	GE	6T58K3721
870101	7	1	PB E-STOP MAIN 2-NC 1-NO	ALLEN-BRADLEY	800TC-FXT6BJXX
-	-	-	-	-	-
869155	8	2	CONTACTOR IEC 9 AMP 24VDC COIL	ALLEN-BRADLEY	100-C09DJ10
868618	9	3	FUSE HOLDER, 1P, NEON, CC CLASS, 30 AMP	ALLEN-BRADLEY	140F-D3C-C30L
868042	10	8	10 AMP FUSE	BUSSMAN	ATQR10
869155	11	1	CONTACTOR IEC 9 AMP 24VDC COIL	ALLEN-BRADLEY	100-C09DJ10
869043	11.1	1	CONTACTOR 140M MTR PROT. 2.5-4.0 AMP	ALLEN-BRADLEY	140M-C2E-B40
869049	11.2	1	CONTACTOR FRONT MOUNT AUX. CONTACT	ALLEN-BRADLEY	140M-C-AFA11
868680	12	2	FUSE 3 AMP 13/32 X 1 1/2	GOULD	ATQR3 OR EQU.
869147	13	1	HOUR METER (HOBBS #85097-02)	ALLIED/HOBBS	611-3002
858231	14	1	FUSE 6 AMP DE	GOULD	ATQR6 OR EQU.
868672	15	32	FUSED TERMINAL BLOCKS	ALLEN-BRADLEY	1492-H5
868678	15.1	32	2 AMP FUSES 1/4 X 1 1/4	GOULD	GDL-2
870563	16	2	RELAY 4 POLE 7 N.O. & 1 N.C. CONTACTS	ALLEN-BRADLEY	700S-DCP710Z24
870267	16.1	1	RELAY SAFETY MONITORING	ALLEN-BRADLEY	440R-N23132
870391	17	2	FUSE HOLDER, 3P, NEON, CC CLASS, 30 AMP	ALLEN-BRADLEY	140F-D3C-30L
871156	18	1	RAIL SWITCH SPIDER 5TX ETHERNET	HIRSCHMANN	943824-002
858332	19	100	TERMAINAL BLOCKS	ALLEN-BRADLEY	1492-H1
858323	19.1	10	TERMINAL BLOCK ANCHORS	ALLEN-BRADLEY	1492-N23
858333	19.2	7	TERMINAL BLOCK END BARRIERS	ALLEN-BRADLEY	1492-N36
858326	19.3	4	TERMINAL BLOCK CHANNEL MOUNT	ALLEN-BRADLEY	1492-N1
868673	19.4	1	TERMINAL BLOCK BARRIERS	ALLEN-BRADLEY	1492-N37
869158	31	1	CONTACTOR IEC 30 AMP 24VDC COIL	ALLEN-BRADLEY	100-C30DJ10
869049	31.1	1	CONTACTOR 140M FRONT MT	ALLEN-BRADLEY	140M-C-AFA11
869075	31.2	1	CONTACTOR 140M MOTOR PROTECTOR	ALLEN-BRADLEY	140M-F8E-C32
871155	23	1	SLC-1500 MICROLOGIX P/SUPPLY 24VDC	ALLEN-BRADLEY	1789-PB2
880004	23.1	1	SLC COMPACT LOGIX PROCESSOR	ALLEN-BRADLEY	1789-L32E
-	23.2	-	-	-	-
868267	23.3	2	SLC-1500 MICROLOGIX INPUT	ALLEN-BRADLEY	1789-IQ16
869889	23.4	1	SLC-1500 MICROLOGIX 16 BIT	ALLEN-BRADLEY	1789-OW16
868928	23.5	1	SLC-1500 MICROLOGIX END PLATE	ALLEN-BRADLEY	1789-ECR
871079	23.6	1	SLC COMPACT LOGIX FLASH/CARD	ALLEN-BRADLEY	1784-CF64
866042	24	3	FUSE 10 AMP	FS	ATQR10
858238	25	1	FUSE 2 AMP	FS	ATQR2
868732	26	5	FUSE 1 AMP	FS	ATQR1
868618	27	10	FUSE HOLDER, 1P, NEON, CC CLASS, 30 AMP	ALLEN-BRADLEY	1492-FB1C30L
870396	28	1	30 AMP 120AC TO 24DC 3PH POWER SUPPLY	ALLEN-BRADLEY	1606-XL480EP
856244	26	1	FUSE 1/2 AMP	FS	ATDR-1/2
870874	31	1	CONTACTOR IEC 23 AMP 24VDC COIL	ALLEN-BRADLEY	100-C23DJ10
869049	31.1	1	CONTACTOR 140M FRONT MT	ALLEN-BRADLEY	140M-C-AFA11
869047	31.2	1	CONTACTOR 140M MOTOR PROTECTOR	ALLEN-BRADLEY	140M-F8E-C20
869897	32	2	150A CIRCUIT BREAKER	GE	SRPE150A150
869820	32.1	6	FUSE 200 AMP CLASS J	GOULD	AJT-200
871512	32.2	6	FUSE DEAD FRONT COVER	GOULD	DFC121
871166	33	1	AC WATT/WATTHOUR TRANSDUCER	OSI	AGH-006E
871167	33.1	2	CURRENT TRANSFORMER (400:5 RATIO)	OSI	12978
870391	34	1	FUSE HOLDER, 3P, NEON, CC CLASS, 30 AMP	ALLEN-BRADLEY	140F-D3C-30L
866042	34.1	3	10 AMP FUSE	BUSSMAN	ATQR10

HARRIS WASTE MANAGEMENT GROUP BAXLEY, GEORGIA		
DATE 9/12 2013	DEALER	CUSTOMER WASTE MANAGEMENT
DRAWN BY: MARK	UL APPROVAL:	MODEL #: HRB 240-T100
SERIAL #: 8831	DRAWING #: 130463SH 8	DESCRIPTION: MCP BOM



A  
B  
C  
D  
E  
F  
G  
H  
I  
J  
K  
L  
M  
N  
O  
P  
Q

**Lire et comprendre toutes les Opérateur/Service Manual instructions avant l'utilisation ou l'entretien de cette machine.**

**Suivez la procédure d'isolation/consignation procédure avant de retirer les protections ou l'ouverture des portes.**



**Read and understand all operator / service manual instructions before operating or servicing this machine.**



**Follow lockout / tagout procedure before servicing machine.**



**Matériel démarre automatiquement.**

**Gardez toutes les parties du corps de la machine pendant l'opération.**

**Suivez la procédure d'isolation/consignation procédure avant de retirer les protections ou l'ouverture des portes.**

  

**Equipment starts automatically.**

**Keep all body parts out of machine during operation.**

**Follow lockout / tagout procedure before removing guards or opening doors.**

<b>CONTROL POWER</b> OFF ON HTR + CHAUFFAGE MARCHÉ ARRÊT					
		<b>DOOR HOME POSITION</b> +		<b>PORTE BALLE HOME</b> +	
<b>BALE DOOR CLOSE</b> +		<b>PORTE BALLE EN PLACE</b> +		<b>EJECTOR EXTEND</b> +	
<b>BALE DOOR OPEN</b> +		<b>PORTE BALLE RETIRÉE</b> +		<b>EJECTOR RETRACT</b> +	

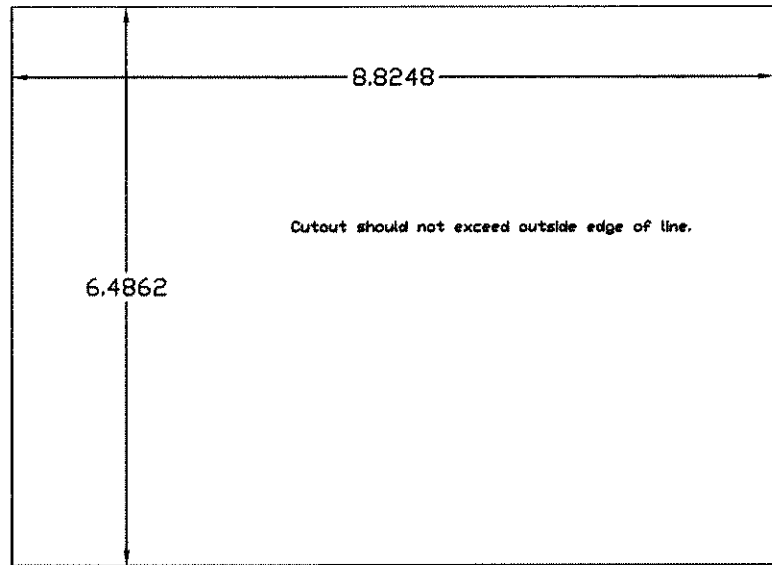

				<b>CONTROLS ON</b> +	
		<b>THROW STRAP</b> +		<b>ENVOI LIGATURE</b> +	
<b>MAIN RAM EXTEND</b> +		<b>EXTENSION POUSSOIR PRINCIPAL</b> +		<b>POSITION MAIN RAM</b> +	
<b>MAIN RAM RETRACT</b> +		<b>RETRACTION POUSSOIR PRINCIPAL</b> +		<b>UBICACION DEL ARRÊT PRINCIPAL</b> +	



HARRIS WASTE MANAGEMENT GROUP BAXLEY, GEORGIA		
DATE 9/12 2013	DEALER	CUSTOMER WASTE MANAGEMENT
DRAWN BY: MARK	UL APPROVAL:	MODEL #: HRB 240-T100
SERIAL #: 8831	DRAWING #: 130463 SH 9	DESCRIPTION: OCS

## OCS BOM

INV #	ITEM	#QTY.	DESCRIPTION	MANUFACTURER	PART NUMBER
871779	A	1	ENCL SLOPE FRONT 20X30 MOD (NO HOLES)	HOFFMAN	C20C30-MOD (NO HOLES)
870662	B	1	PANELIEW PLUS 1000	ALLEN-BRADLEY	2711P-T10C4D2
871027	C	1	LGD PL GRIZZLY ENGLISH/SPANISH	METAL PHOTO	871027
870101	D	1	PB E-STOP MAIN 2-NC 1-NO	ALLEN-BRADLEY	800TC-FXT6BJXX
869144	E	1	PUSH BUTTON WHITE ILL.1-NO CONTACT	ALLEN-BRADLEY	800TC-QA24WD1
858163	F	1	3 POSTION KEYED SEL SWITCH	ALLEN-BRADLEY	800T-J45
871164	F.1	2	N.O. 10AMP RATED CONTACT BLOCK	ALLEN-BRADLEY	800T-XD1M
871165	F.2	2	N.C. 10AMP RATED CONTACT BLOCK	ALLEN-BRADLEY	800T-XD2M
858188	G	3	PB 30MM BLK EXT HEAD W/1-NO	ALLEN-BRADLEY	800TC-B2D1
858158	H	3	SWITCH 3-POS JOYSTICK W/CONT	SQUARE D	9001/K-70-KA2
871092	I	1	POINT I/O ETHERNET ADAPTER 24VDC	ALLEN-BRADLEY	1734-AENT
871094	J	2	POINT I/O 24VDC ANALOG 2 POINT	ALLEN-BRADLEY	1734-IE2C
871093	K	4	POINT I/O 24VDC INPUT MODULE	ALLEN-BRADLEY	1734-IB8
871095	L	2	POINT I/O 24VDC RELAY OUTPUT MODULE	ALLEN-BRADLEY	1734-OW4
871156	M	1	RAIL SWITCH SPIDER 5TX ETHERNET	HIRSCHMANN	943824-002
869963	N	1	MODEM ETHERNET SWITCH 56K DIN RAIL	ALLEN-BRADLEY	9300-RADES
869961	O	1	INTERFACE MOUNT	GRACE PORT	P-R2-F3R0
871115	P	1	ENCL 30X30X12 W/BP	HOFFMAN	A303012LP/A30P30
868678	Q	8	2 AMP FUSES 1/4 X 1 1/4	GOULD	GDL-2
870663	Q.1	8	RELAY 4 POLE 7 N.O. & 1 N.C. CONTACTS	ALLEN-BRADLEY	700S-DCP710Z24
858332	R	70	TERMAINAL BLOCKS	ALLEN-BRADLEY	1492-H1
858323	R.1	4	TERMINAL BLOCK ANCHORS	ALLEN-BRADLEY	1492-N23
858333	R.2	2	TERMINAL BLOCK END BARRIERS	ALLEN-BRADLEY	1492-N36
858326	R.3	1	TERMINAL BLOCK CHANNEL MOUNT	ALLEN-BRADLEY	1492-N1
868673	R.4	1	TERMINAL BLOCK BARRIERS	ALLEN-BRADLEY	1492-N37
871096	S	7	POINT I/O 24VDC BASE	ALLEN-BRADLEY	1734-TB

HARRIS WASTE MANAGEMENT GROUP  
BAXLEY, GEORGIA

DATE 9/12 2013	DEALER	CUSTOMER WASTE MANAGEMENT
DRAWN BY: MARK	UL APPROVAL:	MODEL #: HRB 240-T100
SERIAL #: 8831	DRAWING #: 1304638H 10	DESCRIPTION: OCS BOM

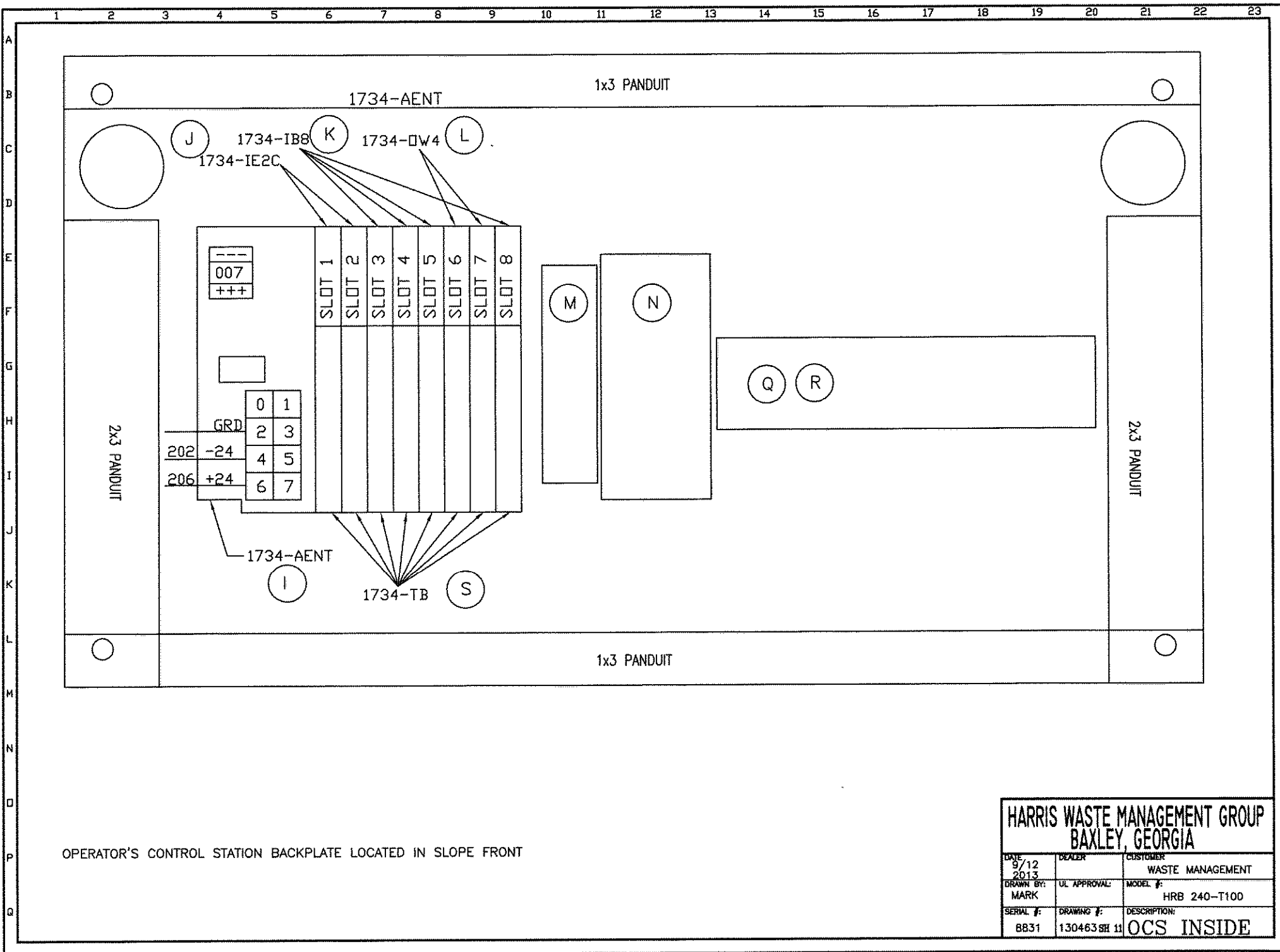

HARRIS WASTE MANAGEMENT GROUP BAXLEY, GEORGIA		
DATE 9/12 2013	DEALER	CUSTOMER WASTE MANAGEMENT
DRAWN BY: MARK	UL APPROVAL:	MODEL #: HRB 240-T100
SERIAL #: 8831	DRAWING #: 130463 SH 11	DESCRIPTION: OCS INSIDE

1 2 3 4 5 6 7 8 9 10 11 12 13 14 15 16 17 18 19 20 21 22 23

A  
B  
C  
D  
E  
F  
G  
H  
I  
J  
K  
L  
M  
N  
O  
P  
Q

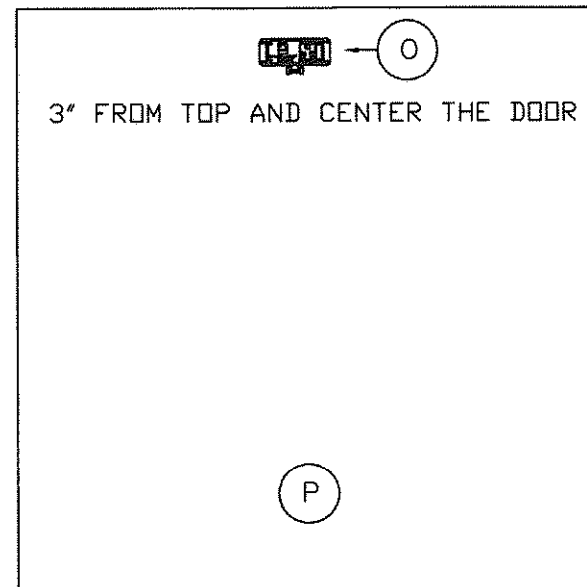
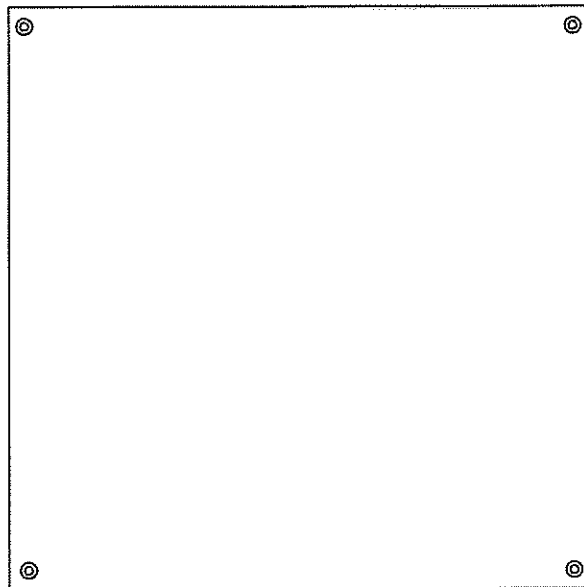

HARRIS WASTE MANAGEMENT GROUP BAXLEY, GEORGIA		
DATE 9/12 2013	DEALER	CUSTOMER WASTE MANAGEMENT
DRAWN BY: MARK	UL APPROVAL:	MODEL #: HRB 240-T100
SERIAL #: 8831	DRAWING #: 130463SH 12	DESCRIPTION: OCS BASE

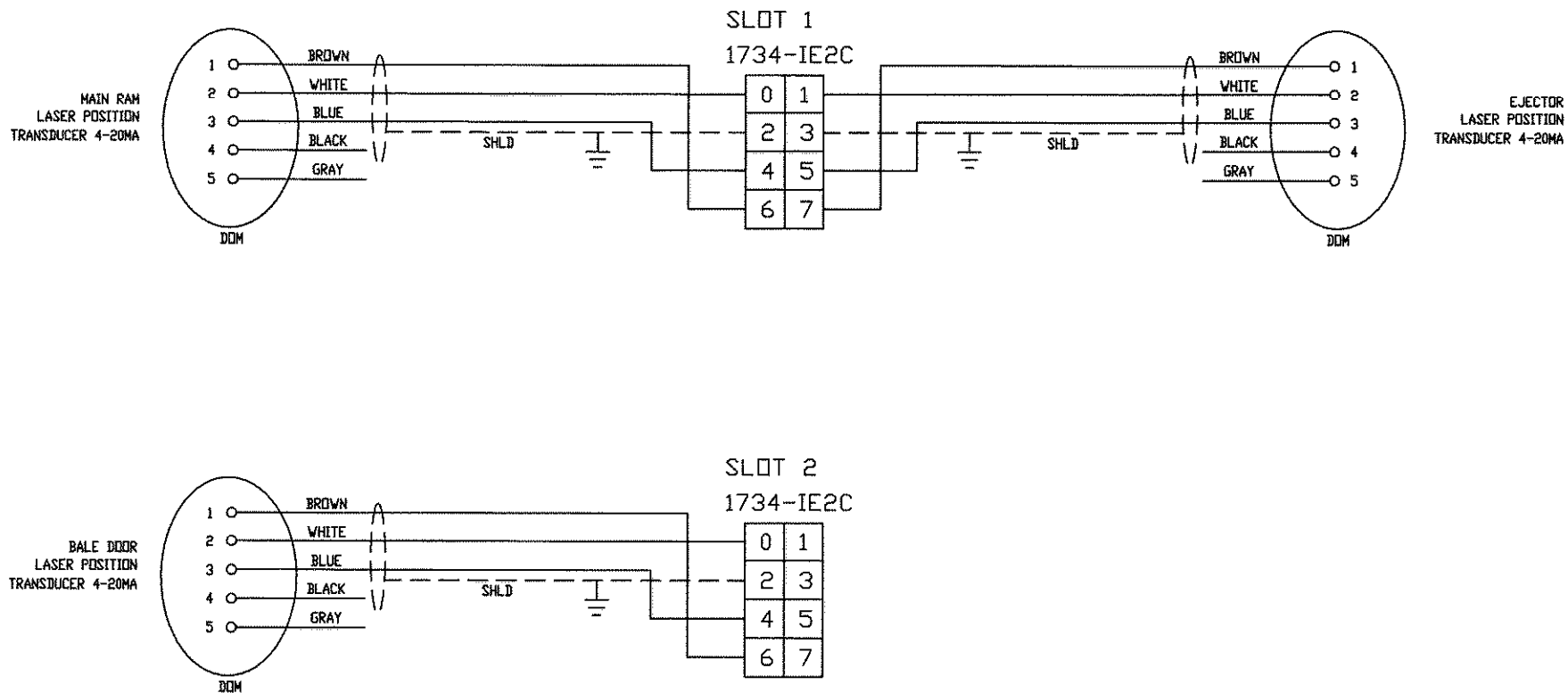

HARRIS WASTE MANAGEMENT GROUP BAXLEY, GEORGIA		
DATE: 9/12 2013	DEALER:	CUSTOMER: WASTE MANAGEMENT
DRAWN BY: MARK	UL APPROVAL:	MODEL #: HRB 240-T100
SERIAL #: 8831	DRAWING #: 13046388 19	DESCRIPTION: OCS ANALOG

+24VDC

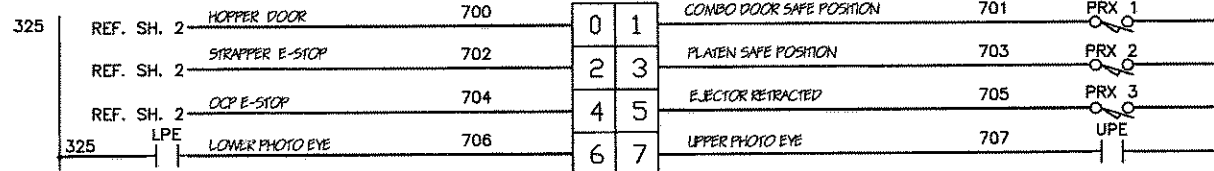

+24VDC

325

HOPPER PHOTO EYES

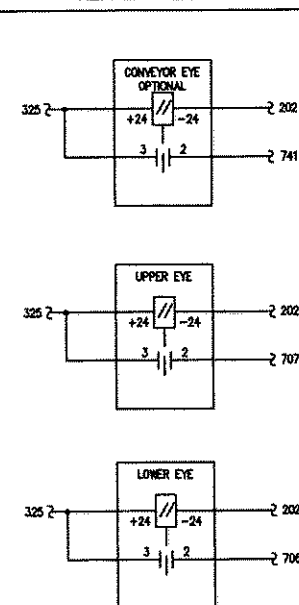

SLOT 4  
1734-IB8

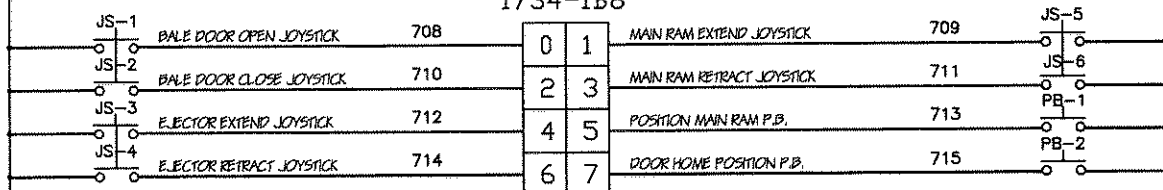

SLOT 5  
1734-IB8

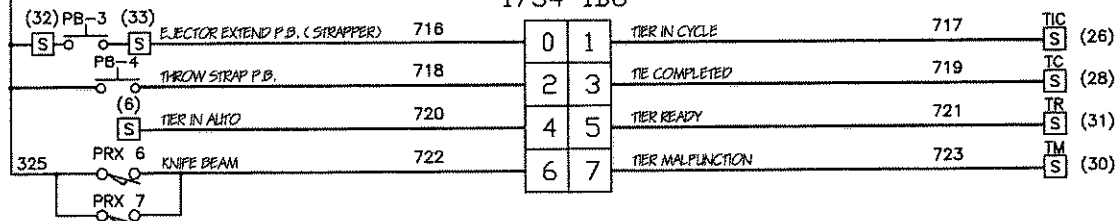

SLOT 8  
1734-IB8

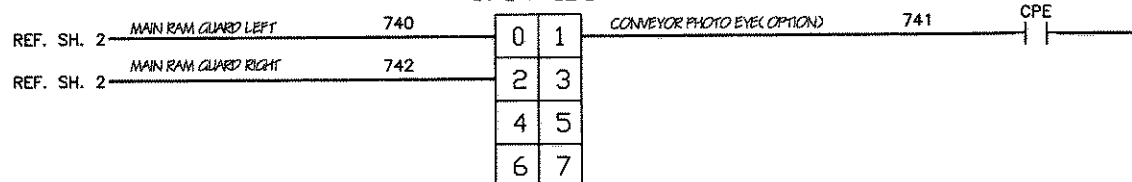

HARRIS WASTE MANAGEMENT GROUP  
BAXLEY, GEORGIA

DATE	DEALER	CUSTOMER
9/12 2013		WASTE MANAGEMENT
DRAWN BY: MARK	UL APPROVAL:	MODEL #: HRB 240-T100
SERIAL #: 8831	DRAWING #: 130463SB 14	DESCRIPTION: OCS INPUTS

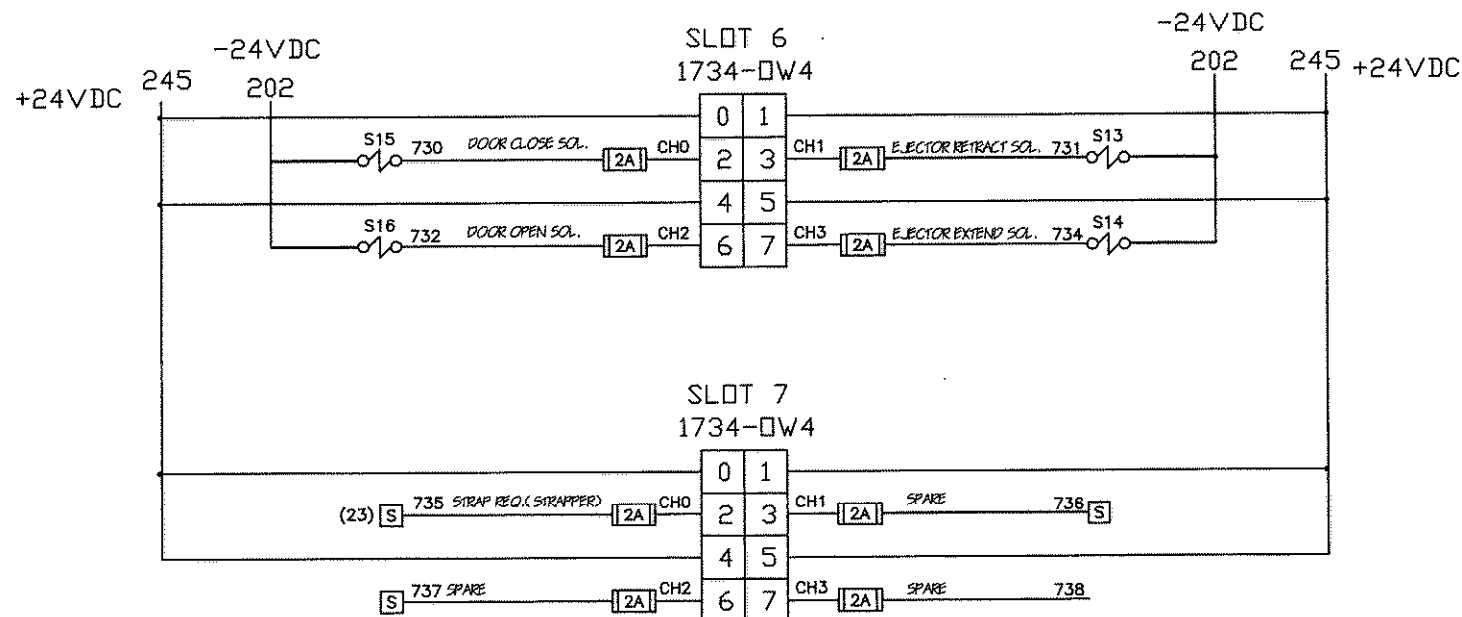

HARRIS WASTE MANAGEMENT GROUP BAXLEY, GEORGIA		
DATE 9/12 2013	DEALER	CUSTOMER WASTE MANAGEMENT
DRAWN BY: MARK	UL APPROVAL:	MODEL #: HRB 240-T100
SERIAL #: 8831	DRAWING #: 130463SEE 15	DESCRIPTION: OCS OUTPUT

