

1" Fixed Focal Length DC Auto-IRIS 50mm F1.8 – C-Mount

Compatible with 1", 2/3" & 1/2" Cameras

SPECIFICATIONS

Focal Length	50mm
Maximum Relative Aperture	1:1.8
Iris	F1.6 - Approx. 360 (With Attenuator)
Angular Field of View	14.6 ° x 10.9 °
Image Format	12.8 x 9.6 mm (Ø16 mm)
Minimum Object Distance	0.7 m (From Front Vertex)
Object Dimensions at M.O.D.	20.5 x 16.1cm
Optical Back Focal Distance	19.71 mm (In Air)

Flange Back	17.526mm
Operation Voltage	Close to Open : Less than 3V Open to Close : More than 0.5V
Operation	Focus Manual Iris IG (Auto Close System)
Operation Temperature	- 10 °C ~ 50 °C / 14 °F ~ 122 °F
Mount	C-Mount (Adjustable Lens Position)
Front Thread	43mm P0.75
Size	62.5(W) x 57(H) x 39(D) mm

DIMENSIONS

UNIT: mm

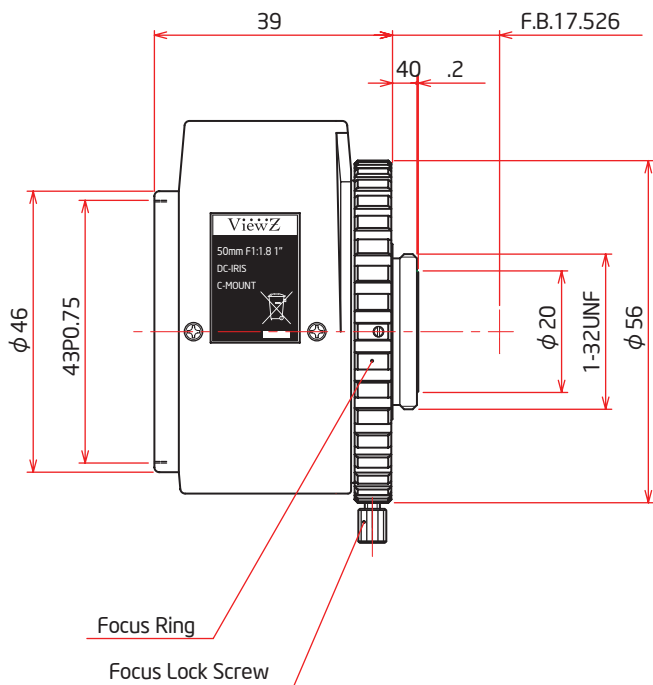
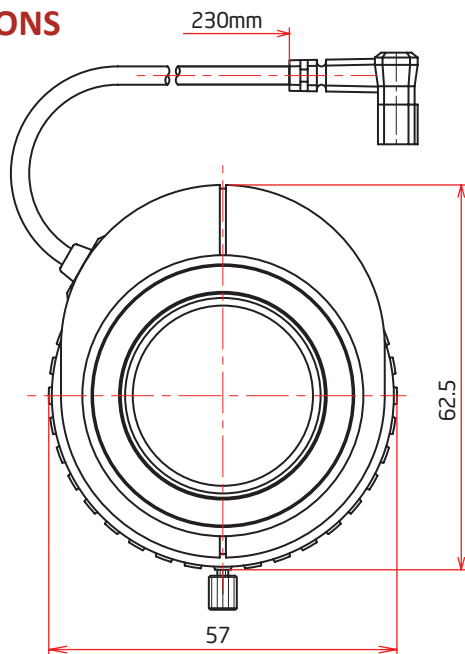

CIRCUIT DIAGRAM

